

4-40 MOUNTING HOLES  
FOR USE WITH ER SERIES RODS  
4 PLACES

SM2 (2.035\"-40) SERIES  
INTERNAL THREAD

FOR INFORMATION ONLY  
NOT FOR MANUFACTURING PURPOSES

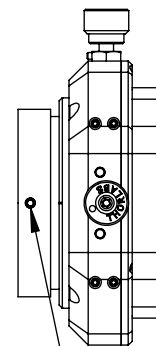

M4 SETSCREW  
2mm [5/64"] HEX  
1 PLACE

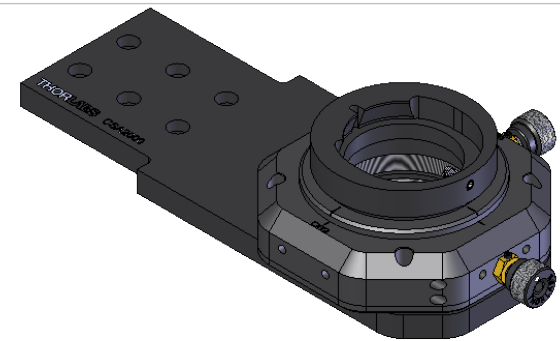

DRAWING  
PROJECTION

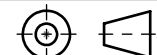

	NAME	DATE
DRAWN	TB	06/JUN/16
APPROVAL	PN	06/JUN/16

COPYRIGHT © 2016 BY THORLABS

VALUES IN PARENTHESIS ARE CALCULATED  
AND MAY CONTAIN ROUND OFF ERRORS

**THORLABS**  
www.thorlabs.com

CONDENSER MOUNTING ARM

MATERIAL	N/A	REV A
----------	-----	----------

ITEM #	CSA2000	APPROX WEIGHT 0.64 kg
--------	---------	--------------------------